

CHRYSLER DODGE LANCIA THEMA CHEROKEE JEEP ESL

S.O.S Car Simulator instruction manual

ESL/ELV REPLACEMENT PROGRAM

Page	Content	MIN. VERSION	PHOTO	PINOUT	VIDEO
Page 2	• Program introduction				
Page 3	• CHRYSLER JEEP DODGE ESL	001			
Page 4	• CHRYSLER / JEEP / GRAND CHEROKEE	001			
Page 5	• DODGE JEEP RAM CHRYSLER	001			
Page 6	• LANCIA THEMA	001			
Page 7	• JEEP RENEGADE CHEROKEE KL FIAT EGEEA	001			





● Program introduction



Example cars

ESL 1

05026132AC
5026464AA
5057278AC

ESL 2

Chrysler
Jeep
Dodge
Grand Cherokee
5026788AD

ESL 3

Chrysler
Jeep Dodge
Grand Cherokee
68166372AB
5026788AD

ESL 4

05026788AC

ESL 5

EEP RENEGADE
CHEROKEE KL
FIAT EGEA

●●● Jumpers to solder

Choose the S.O.S program by soldering the following jumpers depending on your car brand:

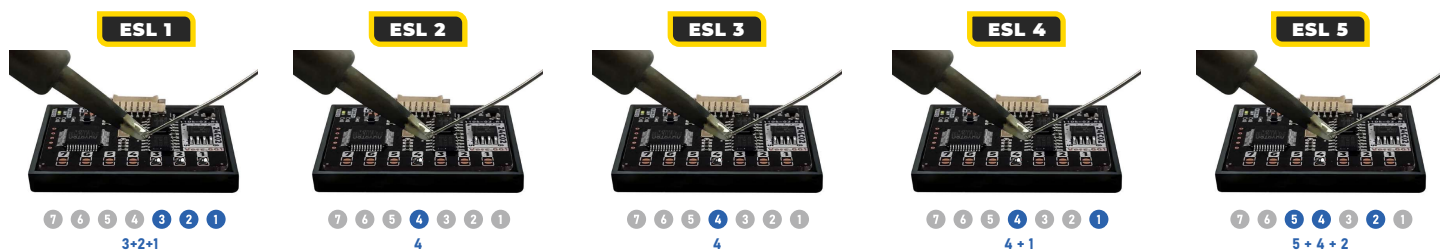

To select the program, you need to solder certain jumpers on the front of the Emulator:

Attention!

Always pul the Emuluator back into the plastic cover before attaching it to the ECU board.

Attaching the Emulator to the ECU board without the plastic cover may resul! in damaging the ECU or the Emulator!

ESL

● CHRYSLER JEEP DODGE ESL

Program Usage

The Emulator can be used with CHRYSLER JEEP DODGE vehicles equipped with a 4-pin SCL plug

Example cars

CHRYSLER JEEP DODGE ESL

- 05026132AC
- 5026464AA
- 5057278AC



●●● Jumpers to solder

1 ” Select the S.O.S program by soldering the jumpers on the right:
3 + 2 + 1

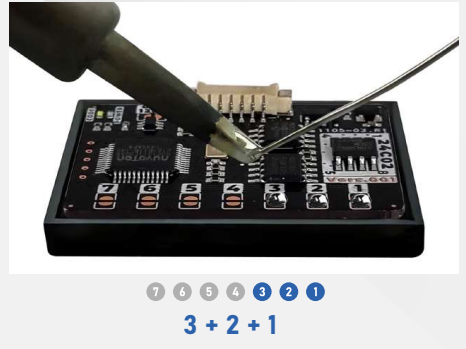

2 ” Connect the Emulator to the SCL plug according to the pictures on the right.

3 ” The original ESL needs to be removed from the car.

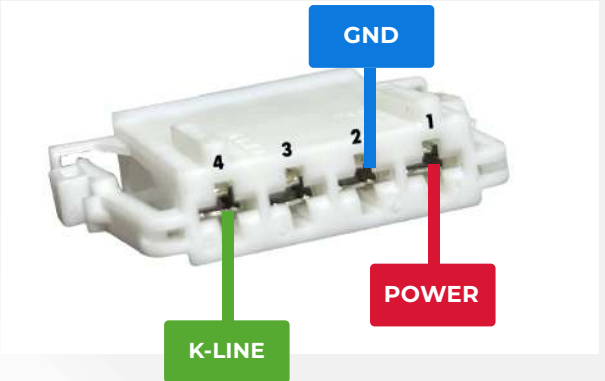
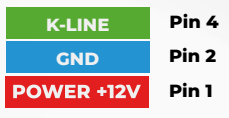



ESL 2

● CHRYSLER / JEEP / GRAND CHEROKEE



Program Usage

The Emulator can be used with CHRYSLER JEEP DODGE vehicles equipped with a 4-pin SCL plug



Example cars

CHRYSLER / JEEP / GRAND CHEROKEE

- Chrysler
- Jeep
- Dodge
- Grand Cherokee
- 5026788AD



●●● Jumpers to solder

1 ” Select the S.O.S program by soldering the jumpers on the right:
4

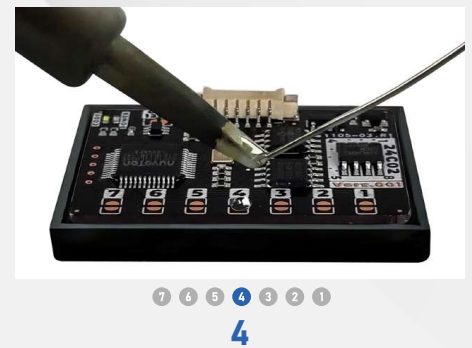

2 ” Connect the Emulator to the SCL plug according to the pictures on the right.

3 ” The original ESL needs to be removed from the car.

K-LINE	Pin 4
GND	Pin 2
POWER +12V	Pin 1

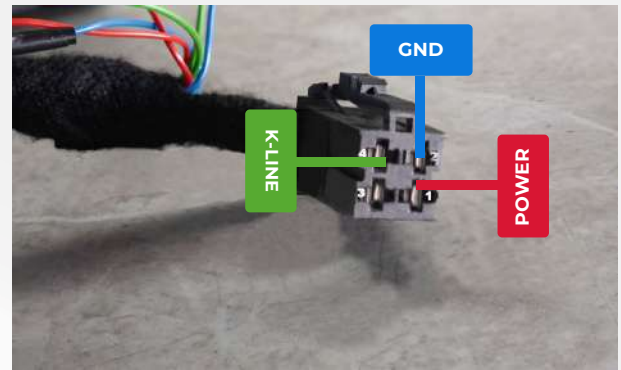

● DODGE JEEP RAM CHRYSLER



Program Usage

The Emulator can be used with DODGE JEEP CHRYSLER vehicles equipped with a 6-pin SCL plug



Example cars

DODGE JEEP RAM CHRYSLER

Chrysler
Jeep Dodge
Grand Cherokee
68166372AB
5026788AD



●●● Jumpers to solder

1 ” Select the S.O.S program by soldering the jumpers on the right:
4

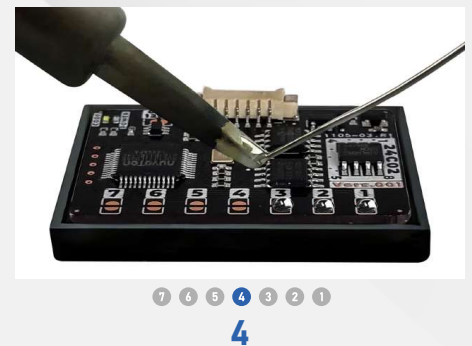

2 ” Connect the Emulator to the SCL plug according to the pictures on the right.

3 ” The original ESL needs to be removed from the car.

K-LINE	Pin 5
GND	Pin 3
POWER +12V	Pin 6

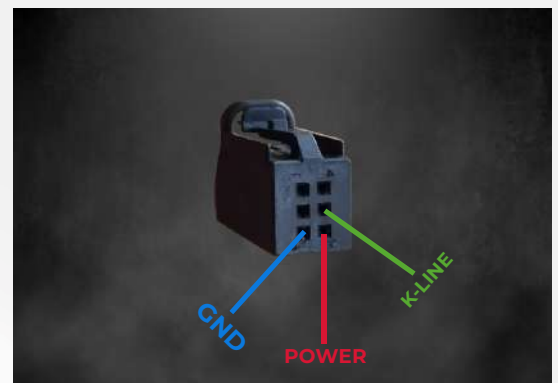

LANCIA THEMA



Program Usage

The Emulator can be used with LANCIA THEMA vehicles equipped with a 4-pin SCL plug



Example cars

LANCIA THEMA

05026788AC



Jumpers to solder

1

Select the S.O.S program by soldering the jumpers on the right: **1 + 4**

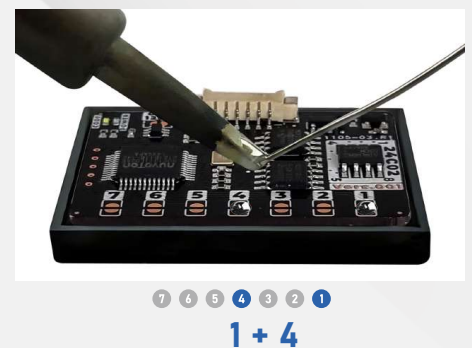

2

Connect the Emulator to the SCL plug according to the pictures on the right.

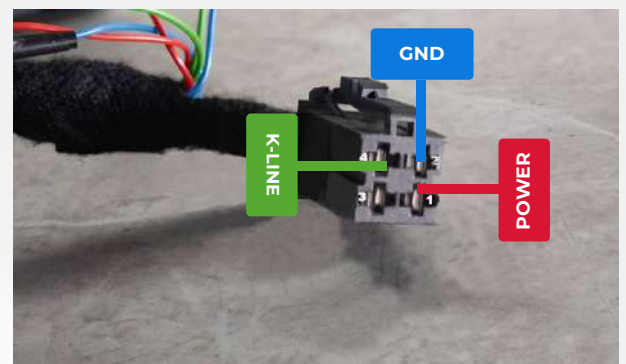

3

The original ESL needs to be removed from the car.

K-LINE	Pin 4
GND	Pin 2
POWER +12V	Pin 1

JEEP RENEGADE CHEROKEE KL FIAT EGEA

Program Usage

The Emulator can be used with JEEP RENEGADE vehicles equipped with a 12-pin SCL plug

Example cars

JEEP RENEGADE

- JEEP RENEGADE
- CHEROKEE KL
- FIAT EGEA



Jumpers to solder

- Select the S.O.S program by soldering the following jumpers: 4 + 5

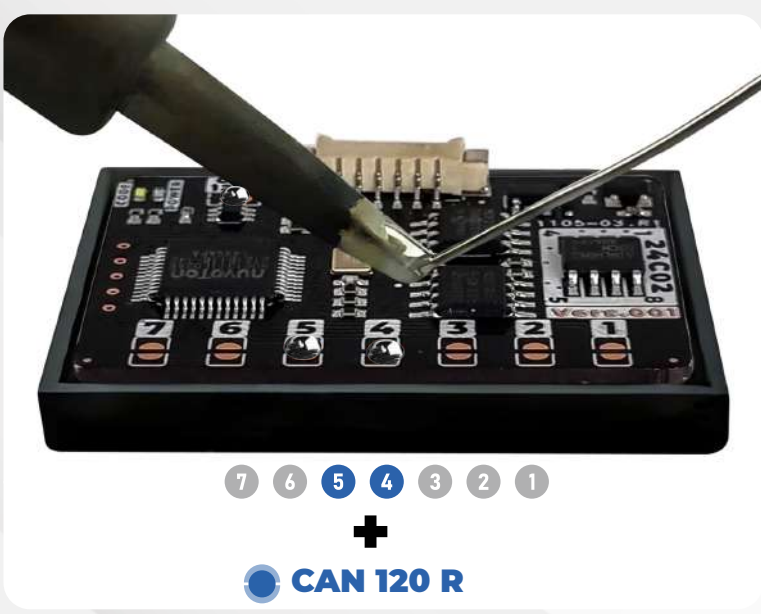

ESL 5

JEEP RENEGADE CHEROKEE KL FIAT EGEA

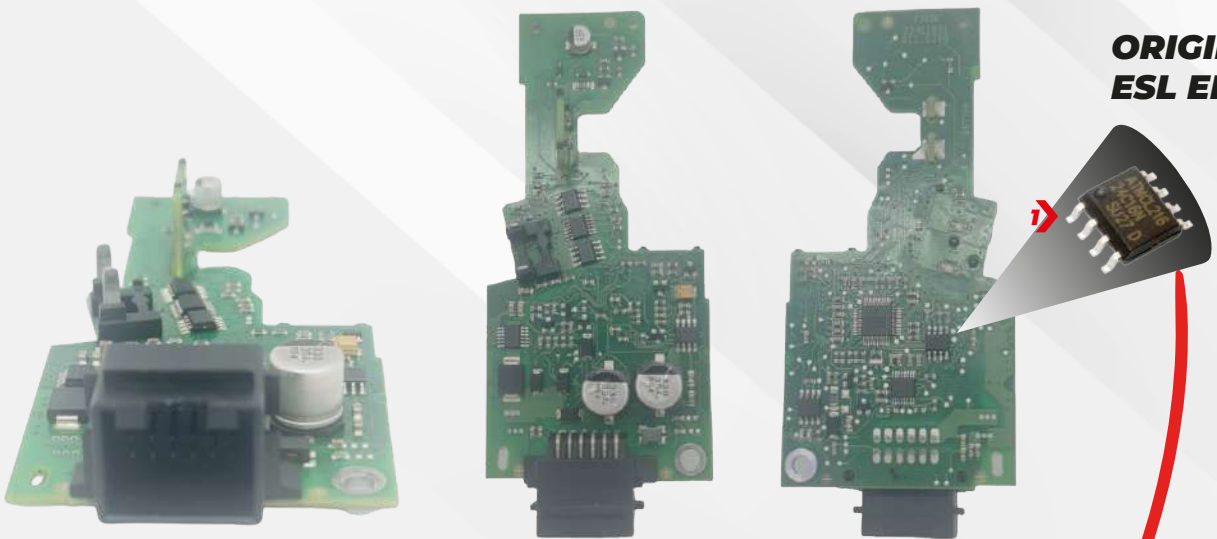

ORIGINAL ESL EEPROM

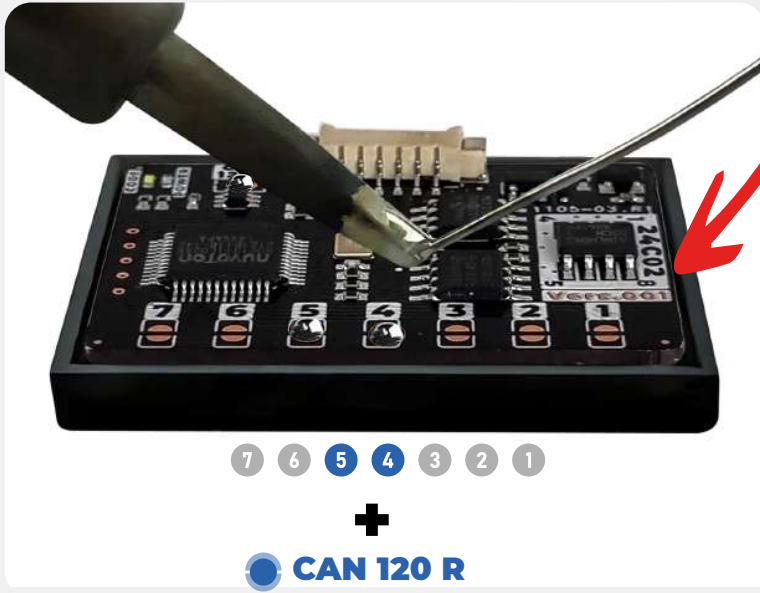

Please Remove The Original Eeprom and Insert the Eeprom into the Emulator

7 6 5 4 3 2 1

+ CAN 120 R

2 Please extract 24c16 or 24c08 eeprom in scl. Take out the 24c02 on the S.O.S emulator and solder the scl original eeprom here

3 Connect the Emulator to the SCL plug according to the pictures on the right.

CAN-L	Pin 10
CAN-H	Pin 9
GND	Pin 5
POWER +12V	Pin 1

4 The original ESL needs to be removed from the car.

